

# Instructions<sup>1</sup> for endocervical swab specimen collection

**WARNING: DO NOT PRE-WET SWAB IN cobas<sup>®</sup> PCR MEDIA BEFORE COLLECTION!**

## ENDOCERVICAL SAMPLE

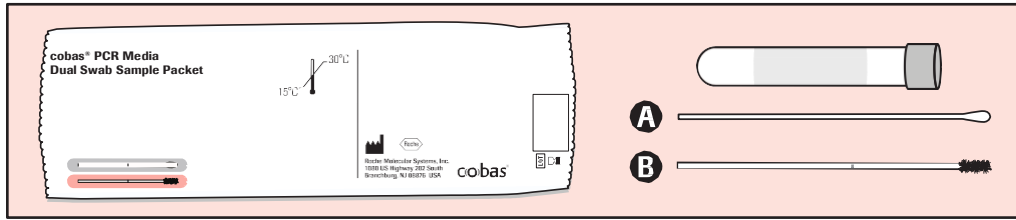

The **cobas<sup>®</sup>** PCR Media Dual Swab Sample kit contains:  
**cobas<sup>®</sup>** PCR Media Tube  
Woven Swab: A  
Flocked Swab: B

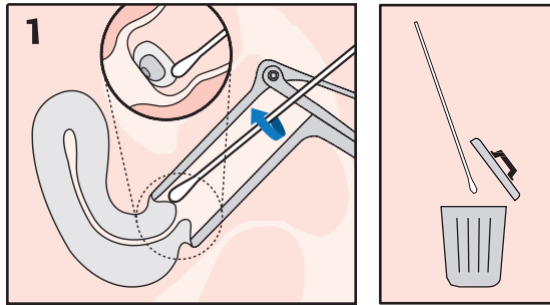

### 1. CLEAN:

Using the woven swab (swab **A** ) , remove **excess mucus** from the cervical os and surrounding mucosa. **Discard the swab** after cleaning.

**NOTE:** Cleaning excess mucus from the cervical os is required to ensure an adequate sample is obtained for processing.

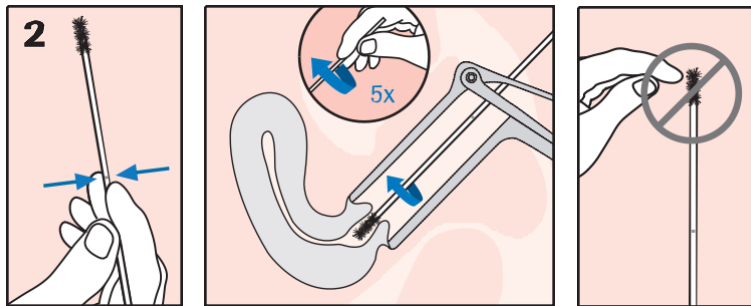

### 2. COLLECT:

To collect the specimen, hold flocked swab (swab **B** ) with the scoreline above your hand and insert into the endocervical canal.

Gently **rotate the swab 5 times in one direction** in the endocervical canal. Do not over-rotate.

Carefully withdraw the swab, avoiding any contact with the vaginal mucosa.

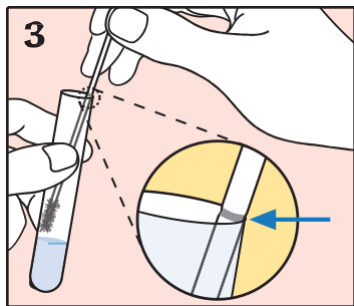

### 3. ALIGN:

Remove the cap from the **cobas<sup>®</sup>** PCR Media Tube and lower the swab specimen into the tube until the visible scoreline on the swab shaft is aligned with the tube rim. The bud of the swab should not be submerged into the liquid prior to breaking the shaft.

**HANDLING PRECAUTIONS:**  
**Use care to avoid splashing of contents.**

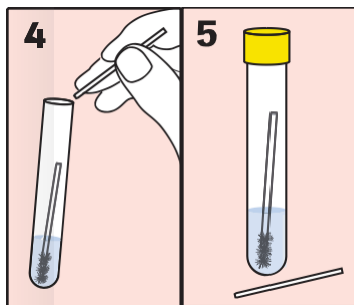

### 4. BREAK:

Carefully leverage the swab against the tube rim to **break the swab shaft at the scoreline**.

### 5. CLOSE:

Tightly re-cap the **cobas<sup>®</sup>** PCR Media tube. The specimen is now ready for transport.

**Discard the top portion of the swab.**

**Transport:** 2°C to 30°C ▪ **Stability of sample:** 12 months

### THE SPECIMEN WILL BE REJECTED IF THERE IS:

- Presence of two swabs within the same tube
- No swab within the tube
- Excess of blood (>5%)

