

# Instructions<sup>1</sup> for throat swab specimen collection

**WARNING: DO NOT PRE-WET SWAB IN cobas® PCR MEDIA BEFORE COLLECTION!**

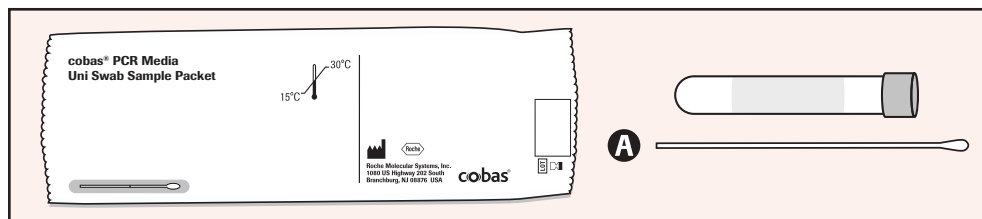

The **cobas®** PCR Media Uni Swab Sample kit contains:  
**cobas®** PCR Media Tube  
Woven Swab: A

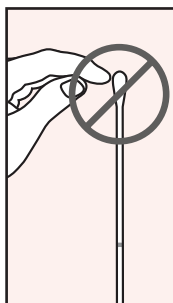
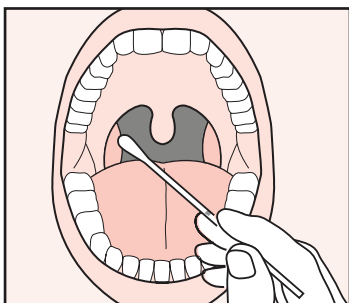
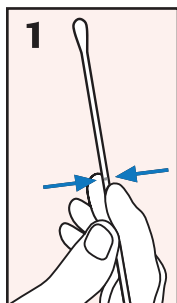

## 1. COLLECT:

To collect the specimen, hold the swab with the scoreline above your hand and insert the swab into the mouth and collect the specimen from the bilateral posterior pharynx both tonsils, and the uvula.

Withdraw the swab carefully. **Do not let the swab touch any surface** before placing it into the collection tube.

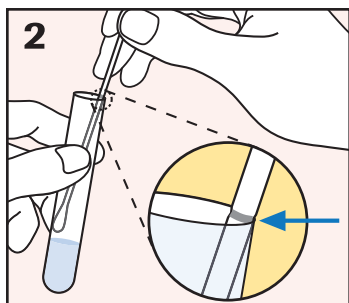

## 2. ALIGN:

Remove the cap from the **cobas®** PCR Media Tube and lower the swab specimen into the tube until the visible scoreline on the swab is aligned with the tube rim. The tip of the swab should not be submerged into the liquid prior to breaking the shaft.

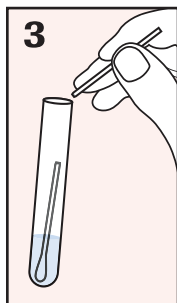

## 3. BREAK:

Carefully leverage the swab against the tube rim to **break the swab shaft at the scoreline**.

## HANDLING PRECAUTIONS:

**Use care to avoid splashing of contents.**

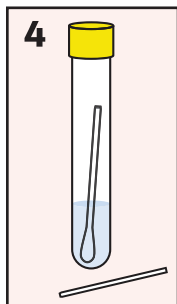

## 4. CLOSE:

Tightly re-cap the **cobas®** PCR Media tube. The specimen is now ready for transport.

**Discard the top portion of the swab.**

**Transport:** 2°C to 30°C ▪ **Stability of sample:** 12 months

## THE SPECIMEN WILL BE REJECTED IF THERE IS:

- Presence of two swabs within the same tube
- No swab within the tube
- Excess of blood (>5%)



<sup>1</sup> Individuals collecting or directing the collection of samples should consult the complete instructions for use.