

# S-Monovette®

*The enclosed blood collection system*



East Suffolk and North Essex  
NHS Foundation Trust

East Suffolk and North Essex NHS Foundation Trust

Colour Code	Investigation	Colour Code	Investigation
<p>White Serum</p>	<p>Immunology e.g. ANA, DNAA, ANCA, Screening Rubella, Down's and N.T.D's, Hepatitis, other Microbiology. <b>NB</b> contains clotting activator on beads</p>	<p>Red EDTA K</p>	<p>FBC, Red cell folate, I.M, S Test, Malarial screen, HbA<sub>1c</sub>, Cyclosporin <b>NB</b> must be mixed well to avoid platelet clumping and clots</p>
<p>Brown Serum Gel</p>	<p>Most Biochemistry except glucose</p>	<p>Mauve ESR</p>	<p>ESR only Smaller Paediatric S-Monovettes available on request (2.7ml) <b>NB</b> S-Sedivettes must be filled to the bottom of cap Must be mixed well</p>
<p>Orange Lithium Heparin</p>	<p>Cytogenetics Special Biochemistry test</p>	<p>Green Coagulation</p>	<p>Clotting screen (Pt and APTT) Warfarin control (INR) Heparin control (APTR) DIC Screen, Lupus inhibitor, Thrombophilia Screen. <b>NB</b> must be filled to mark and mixed well immediately after collection to avoid activating coagulation system</p>
<p>Yellow Fluoride</p>	<p>Blood Glucose Blood Alcohol <b>NB</b> Must be mixed. Contains Enzyme Inactivator</p>	<p>Blue EDTA K Blood Transfusion</p>	<p>Blood Transfusion and antenatal blood group serology</p>

## Order of Draw for Multiple Sampling

According to Gurr<sup>1</sup>:

Blood culture



Serum/Serum-Gel blood



Citrate blood



Heparin/Heparin-Gel blood



EDTA blood



Fluoride/Citrate-fluoride blood

According to CLSI<sup>2</sup>:

Blood culture



Citrate blood



Serum/Serum-Gel blood



Heparin/Heparin-Gel blood



EDTA blood



Fluoride/Citrate-fluoride blood

## With S-Monovette® you have the choice:

Aspiration principle

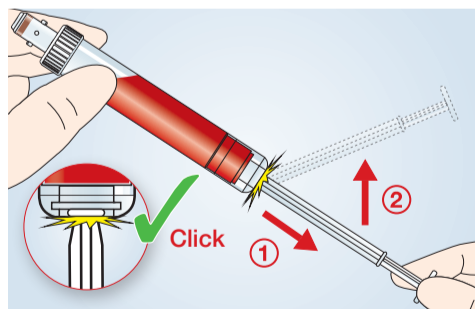
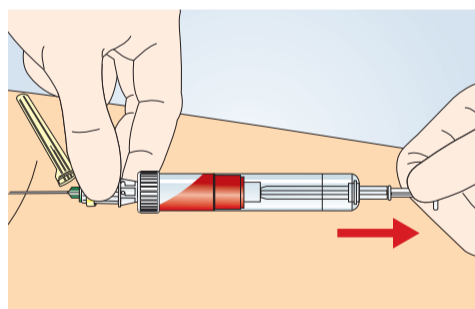
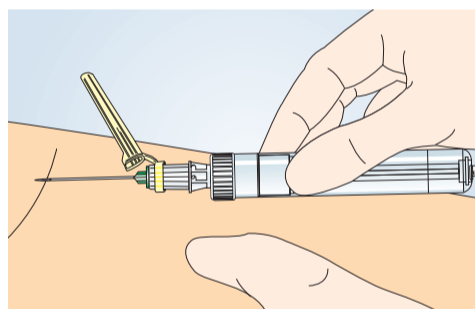

Vacuum principle<sup>3</sup>

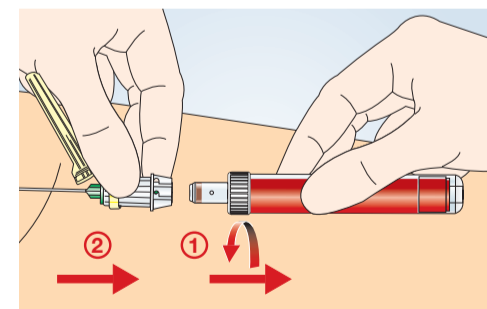
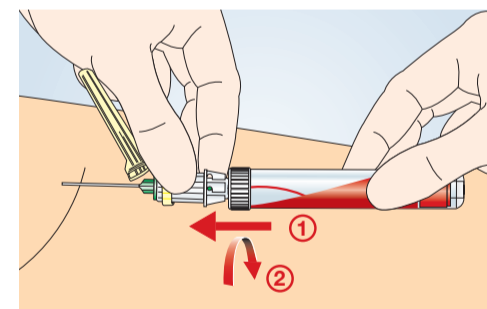
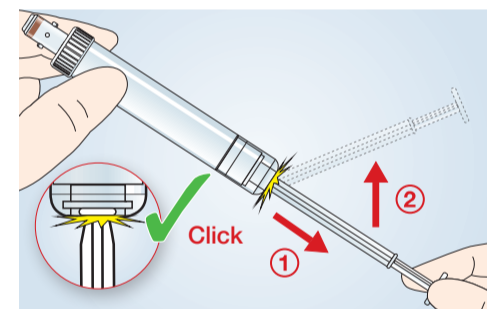

<sup>1</sup> Gurr et al "Musterstandardarbeitsanweisung Präanalytik" J Lab Med 2011

<sup>2</sup> CLSI GP41 Procedures for the Collection of Diagnostic Blood Specimens by Venipuncture (former CLSI H3-A6)

<sup>3</sup> To begin blood collection gently, we generally recommend using the first S-Monovette® with the aspiration method. Then continue with the vacuum method.

## Needles and adapters - can be individually combined with the S-Monovette®

